

Mini bleeder valve

brass, not type-tested

EASY

Art. No. 103914

Type No. 218.26

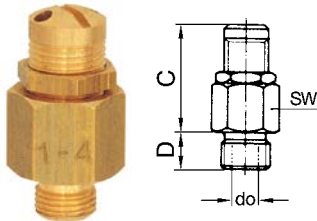

Exemplary illustration

Manual adjustment of the blow-off pressure (lock nut).

For compressed air and non-toxic, non-flammable gases, cannot be used for liquids due to free blow-off, not suitable for steam.

Technical data

| | |
|-----------------------|--|
| Operating pressure | 0.5 - 60 bar |
| Operating temperature | -20 to 180 °C |
| Set pressure | 30 - 60 bar |
| Sealant | FKM 75, 75+5 Sh.A black, thickness of 2 mm |
| Max. blow-off rate | 3000 l/min |
| Thread | G 1/4 |
| C | 27.0 mm |
| D | 7.0 mm |
| a/f | 16 mm |
| do | 3.0 mm |

Commercial data

| | |
|-------------------------|------------------|
| Customs tariff number | 84814090 |
| Country of origin | DE |
| eCl@ss 5.1.4 | 27292490 |
| eCl@ss 9.0 | 27292490 |
| UNSPSC_Code_v190501 | 40141603 |
| UNSPSC_CodeDesc_v190501 | Pneumatic valves |

Material informations

| | |
|----------------------------|-------------------------|
| REACH SVHC1 substance name | lead |
| CAS no. SVHC 1 | 7439-92-1 |
| RoHS materials notice | RoHS compliant |
| REACH Info | contains SVHC substance |

Dimensions

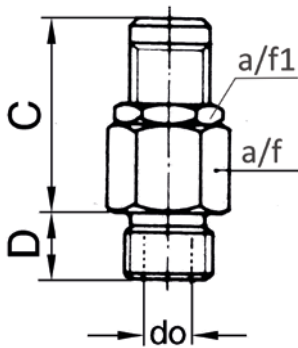

| Thread | C | D | a/f | SW 1 | Female thread | do |
|--------|-------------|-----|-----|------|---------------|-----|
| | mm | mm | mm | mm | mm | mm |
| G 1/4 | 27.0 - 34.0 | 7.0 | 16 | 14 | M12x1 | 3.0 |