

## Mini bleeder valve

brass, not type-tested

**EASY**

Art. No. 103909

Type No. 218.21

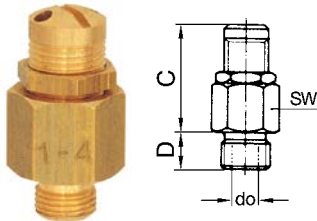

Exemplary illustration

Manual adjustment of the blow-off pressure (lock nut).

For compressed air and non-toxic, non-flammable gases, cannot be used for liquids due to free blow-off, not suitable for steam.

### Technical data

Operating pressure	0.5 - 60 bar
Operating temperature	-20 to 180 °C
Set pressure	1 - 4 bar
Sealant	FKM 75, 75+5 Sh.A black, thickness of 2 mm
Max. blow-off rate	200 l/min
Thread	G 1/4
C	27.0 mm
D	7.0 mm
a/f	16 mm
do	3.0 mm

### Commercial data

Customs tariff number	84814090
Country of origin	DE
eCl@ss 5.1.4	27292490
eCl@ss 9.0	27292490
UNSPSC_Code_v190501	40141603
UNSPSC_CodeDesc_v190501	Pneumatic valves

## Material informations

REACH SVHC1 substance name	lead
CAS no. SVHC 1	7439-92-1
RoHS materials notice	RoHS compliant
REACH Info	contains SVHC substance

## Dimensions

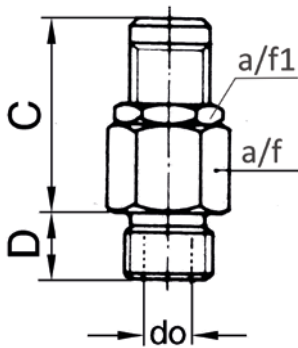

Thread	C	D	a/f	SW 1	Female thread	do
	mm	mm	mm	mm	mm	mm
G 1/4	27.0 - 34.0	7.0	16	14	M12x1	3.0