



**ARE YOU AT A DEAD
END? THEN WE'VE
GOT SOMETHING
FOR YOU.**

**Our »speedfit« and »sharkbite«
compressed air pipe systems.**

The »speedfit« and »sharkbite« pipe systems are ideally suited to transporting compressed air. Both can be installed quickly and easily by yourself and offer significant savings in terms of energy and labor compared to conventional methods. Convert your compressed air piping systems with minimal production downtime and costs.

»speedfit« series

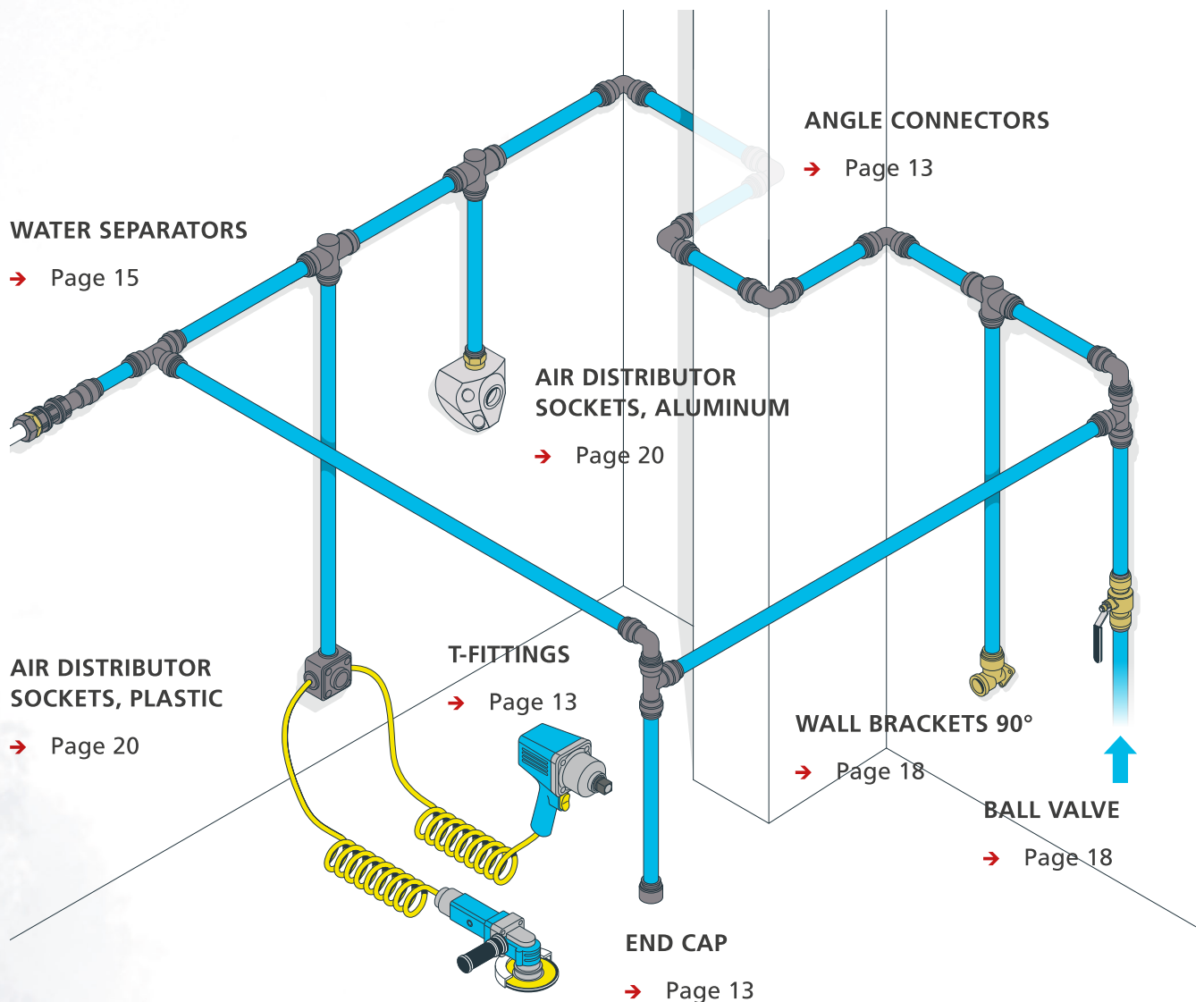

The »speedfit« and »sharkbite« series consist of reliable, long-lasting, and efficient plug-in connectors, pipes, and accessories. Both are durable and corrosion-resistant, and no additional sealing material is required for their installation.

You get optimum flow rate and the utmost air quality. You also extend the lifespan of your systems and installations.

»sharkbite« series

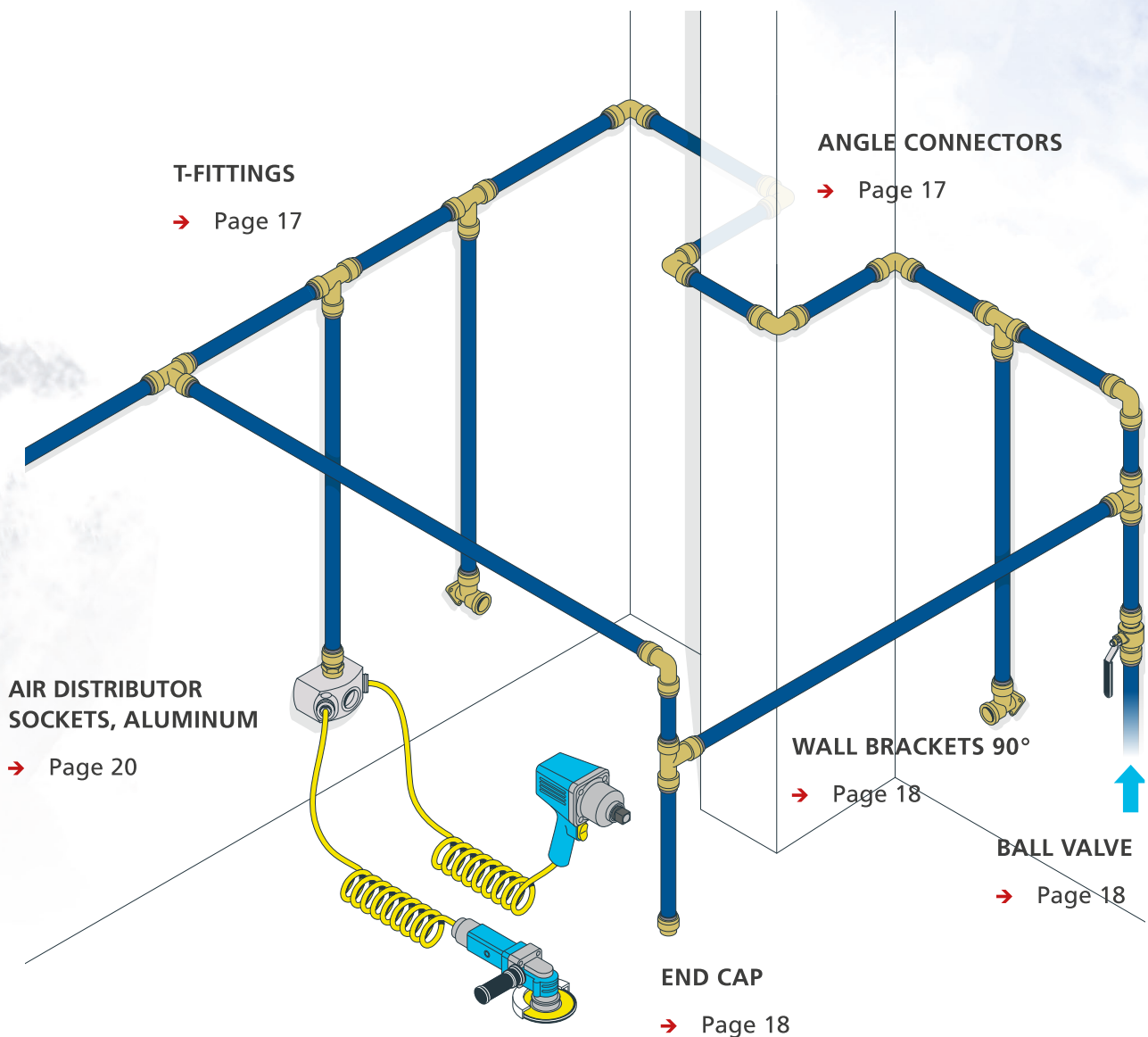

»speedfit« series

PIPE STOPPER

- Ensures that the pipe is fully plugged in.

HOLDING ELEMENT WITH STAINLESS STEEL TEETH

- Holds the pipe in place and permits simple detachment of the connection with no tools required.

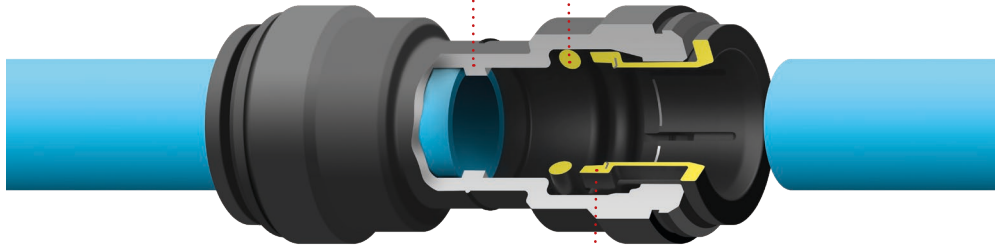

PLASTIC CASING

- Forms a robust body.

INTERNAL O-RING SEAL (NBR)

- Creates a lasting, reliable seal.

»sharkbite« series

BRASS CASING

- Forms a robust body.

INTERNAL O-RING SEAL (NBR)

- Creates a lasting, reliable seal.

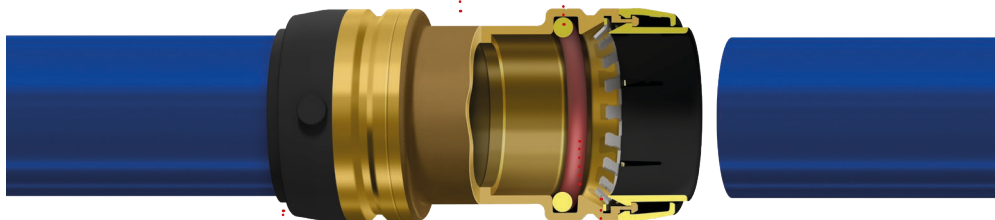

RELEASE CLIP & RELEASE AID

- Permits safe pipe removal.

PREDUCTIVE CAP

- Ensures the stability of the release ring and aligns the pipe.

STAINLESS STEEL HOLDING ELEMENT

- Grips the pipe and holds it in place.

GREAT FLOW PROPERTIES AND IMMENSE PRODUCT DIVERSITY: THE HALLMARKS OF BOTH SYSTEMS.

- Quick, easy, and reliable pipe connections
- Plastic pipes in rigid or rolled form
- Plastic pipes certified according to DVGW, KTW, NSF, and WRAS
- Aluminum pipes
- Acetal copolymer connectors (POM) in sizes from 4 to 28 mm – »speedfit« series
- Brass connectors in sizes from 15 to 54 mm – »sharkbite« series
- Accessories for both series
- NBR O-rings and holding elements with stainless steel teeth
- Suitable for compressed air applications (up to 10 or 20 bar) and vacuum applications (coarse and fine vacuum)
- A versatile solution for connecting metal or plastic pipes
- Quick-and-easy system reconfiguration and expansion with minimum downtime
- Reliable, leak-proof solution that grips before it seals and can resist high pressure
- Immediate plug-in connection without any hot work, silicone, solvents, or adhesives required
- Corrosion-free solution that extends the lifecycle of systems and reduces maintenance
- Lightweight, easy-to-handle material
- A versatile solution for connecting metal or plastic pipes

DO YOU WANT TO KNOW THE EASIEST WAY TO CARRY OUT YOUR INSTALLATION?

- First attach the wall brackets only for the pipes running horizontally.
- Put the system under pressure and check it for tightness. Only then should you attach the vertical wall brackets and the compressed air tapping point. This way, you prevent the vertical pipes from running crookedly.
- If the compressed air piping system is installed around a pillar, please plan for an appropriate distance between the wall and the distributor. We recommend a wall distance of 30 cm.
- Please also allow a minimum distance of 10 cm between the connector and the wall bracket (pipe clamp).
- If the pipework is to extend over longer distances, please incorporate an expansion arc every 25 meters.
- As a basic rule, we recommend use of a moisture trap in compressed air piping systems. This way, the condensation will collect at one specific point and your pipes are protected.

A few key installation take-aways are summarized for you here:

- Mount the pipe brackets so that you have enough clearance to slide the pipe back and forth.
- Make sure there are no burrs on the pipe ends. This way, you avoid any damage to the O-rings of the connectors.
- Give pipes a chamfered edge to reduce the insertion force.
- Cut the pipes using the designated pipe-cutter only.
- Always insert the pipes into the connector as far as they will go. This prevents any loss of pressure in the system.

Cutting the pipes

- ➔ Always make certain the pipes have a straight cut. Ideally use our plastic pipe clippers or the aluminum pipe cutter.
- ➔ Remove burrs and sharp edges to prevent damage to the O-ring of the connector.

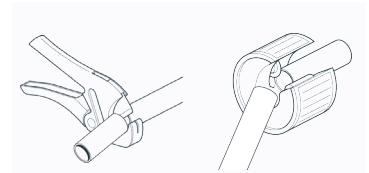
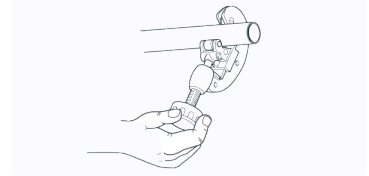

Attaching and detaching connectors in the »speedfit« series

ATTACHING CONNECTORS.

- ➔ Push the pipe into the connector as far as it will go.

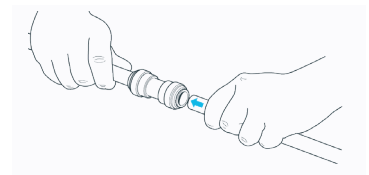

CHECKING THE CONNECTIONS.

- ➔ Pull gently on the pipe to check whether it is plugged securely into the connector.

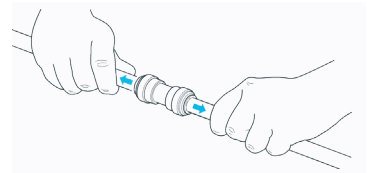

DETACHING CONNECTORS.

- ➔ Ensure the entire system is free of pressure. Push back the holding element on the connector to release and remove the pipe.

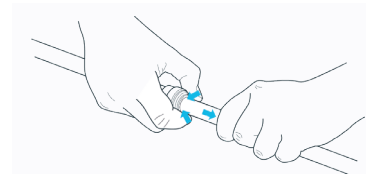

DEALING WITH SCREW-CAP CONNECTORS.

- ➔ A quarter-turn of the screw cap clockwise reduces the movement of the pipe and ensures that the pipe is secured in the holding element.
- ➔ Pull gently on the pipe to check whether it is plugged securely into the connector.
- ➔ Another quarter turn on the screw cap anti-clockwise will release the pipe in the holding element.
- ➔ You can then press on the holding element to disconnect the pipe completely.

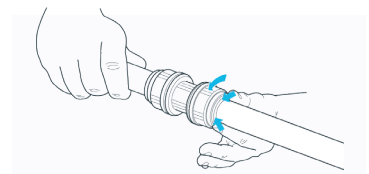
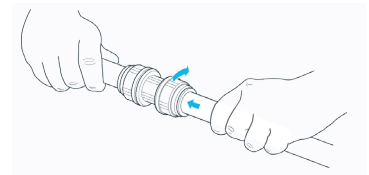

Attaching and detaching connectors in the »sharkbite« series

MEASURE THE PLUG-IN DEPTH.

- Use the release clip, the deburring tool, or a tape measure to mark the plug-in depth on the pipe.

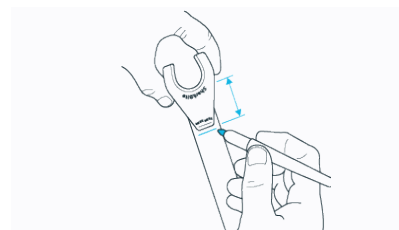

ATTACHING CONNECTORS.

- Position the pipe at a right angle – with the aid of the detachment ring of the plug-in connector. Press the pipe into the connector with a gentle turn as far as it will go. If you are using plastic pipes, we recommend using a support sleeve unless your pipe manufacturer recommends otherwise.

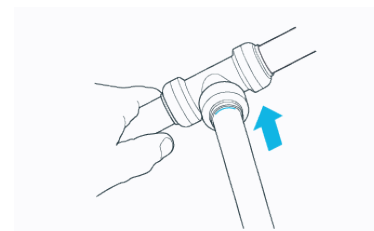

CHECKING THE CONNECTIONS.

- Pull gently on the pipe to make certain it is plugged securely into the connector.

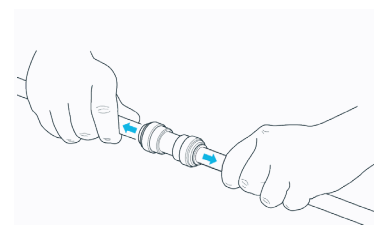

DETACHING CONNECTORS.

- Ensure the entire system is free of pressure.

DISCONNECTION FOR SIZES 15–28 mm WITH THE AID OF A RELEASE CLIP.

- Hold the connector in your hand and place the release clip over the pipe so that the logo faces away from the connector.
- Slide the clip up to the detachment ring and press firmly on the two »finger pads« while simultaneously turning the pipe and pulling to release it.

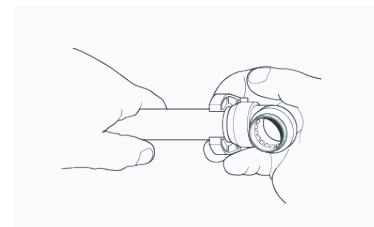

DISCONNECTION FOR SIZES 35–54 mm WITH THE AID OF A RELEASE CLIP.

- Place the release aid over the pipe and position the slots over the two bolts in the end cap. Turn the clamp clockwise 10° until it locks into place, then twist and pull the pipe out of the connector.

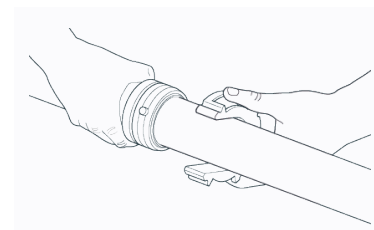

**DISCOVER THE
FULL RANGE OF THE
»SHARKBITE« AND
»SPEEDFIT« SERIES.**



Plastic pipes made of polyamide PA 12

»speedfit« and »sharkbite« series – in rigid form

- ➔ Resistant to corrosion, vibration, impact, ageing, high pressures and heat.
- ➔ Only available in complete packaged units!
- ➔ Operating pressure with 2.5 times the safety!

Material	PA 12, hard (according to DIN 73378)
Operating temperature	-60 to 100 °C
Pipe length	3 m

Plastic pipes made of polyamide PA 12

Item no.	Type no.	Pipe Ø, external (mm)	Pipe Ø, internal (mm)	Max. operating pressure at 20 °C (bar)	Packaging unit (pc.)	Color
113997	89.1209-B-10	12	9	38	10	Blue
113987	89.1209-B	12	9	38	20	Blue
113998	89.1209-S-10	12	9	38	10	Black
113988	89.1209-S	12	9	38	20	Black
113999	89.1512-B-10	15	12	25	10	Blue
113989	89.1512-B	15	12	25	20	Blue
114000	89.1512-S-10	15	12	25	10	Black
113990	89.1512-S	15	12	25	20	Black
114001	89.1814-B-10	18	14	28	10	Blue
113991	89.1814-B	18	14	28	20	Blue
114002	89.1814-S-10	18	14	28	10	Black
113992	89.1814-S	18	14	28	20	Black
114003	89.2218-B-10	22	18	22	10	Blue
113993	89.2218-B	22	18	22	20	Blue
114004	89.2218-S-10	22	18	22	10	Black
113994	89.2218-S	22	18	22	20	Black
114005	89.2823-B-5	28	23	20	5	Blue
113995	89.2823-B	28	23	20	10	Blue
114006	89.2823-S-5	28	23	20	5	Black
113996	89.2823-S	28	23	20	10	Black



89.1209-B



89.1209-S

Plastic pipes made of polyamide PA 12

»speedfit« and »sharkbite« series – in rolled form

- ➔ Resistant to corrosion, vibration, impact, ageing, high pressures and heat.
- ➔ Operating pressure with 2.5 times the overpressure safety!

Material	PA 12, hard (according to DIN 73378)
Operating temperature	-60 to 100 °C

Plastic pipes made of polyamide PA 12, blue

Item no.	Type no.	Hose Ø, external (mm)	Hose Ø, internal (mm)	Max. operating pressure at 20°C (bar)	Roll length (m)
114007	94.12-25	12	9	19	25
114008	94.15-25	15	12	15	25
114009	94.18-25	18	14	16	25
114010	94.22-25	22	18	14	25
114011	94.12-100	12	9	19	100
114012	94.15-100	15	12	15	100
114013	94.18-100	18	14	16	100
114014	94.22-100	22	18	14	100
114015	94.28-50	28	23	14	50



94.12-25

Plastic pipes made of LLDPE/LDPE

»speedfit« and »sharkbite« series – in rolled form

- Plastic pipes made of LLDPE/LDPE with approvals ratings as per DVGW worksheet W270, KTW, NSF and WRAS.
- LLDPE/LDPE pipes are suitable for drinking water applications (cold water) with a maximum chlorine content of 4 parts per million (ppm). Warm water over 20 °C and / or pressure loads above the specified maximum will reduce the lifespan of this material. Direct exposure to sunlight should also be avoided.

Operating temperature -20 to 65 °C

Plastic pipes made of LLDPE/LDPE. black

Item no.	Type no.	Hose Ø. external (mm)	Hose Ø. internal (mm)	Max. operating pressure at 20 °C (bar)	Roll length (m)	Material
136361	97.04-100	4	2.5	15	100	LLDPE
136362	97.06-100	6	4.0	15	100	LLDPE
136363	97.08-100	8	6.0	10	100	LLDPE
136364	97.10-100	10	7.0	10	100	LLDPE
136365	97.12-100	12	9.0	10	100	LLDPE
136366	97.15-100	15	11.5	10	100	LLDPE
136367	97.22-50	22	17.7	6	50	LDPE



97.15-100

Aluminum pipes

»speedfit« and »sharkbite« series

- Resistant to corrosion, electrically insulating.
- Only available in complete packaged units!

Material Surface-coated aluminum
 Max. operating pressure 20 bar
 Operating temperature -20 to 65 °C
 Pipe length 3 m
 Color Blue

Aluminum pipes, surface-coated

Item no.	Type no.	Pipe Ø, external (mm)	Pipe Ø, internal (mm)	Packaging unit (pc.)
152287	90.1513-BE-10	15	13	10
152263	90.1513-BE	15	13	20
152293	90.1816-BE-10	18	16	10
152264	90.1816-BE	18	16	20
152294	90.2220-BE-10	22	20	10
152265	90.2220-BE	22	20	20
152297	90.2826-BE-5	28	26	5
152266	90.2826-BE	28	26	10
117010 NEW	ALR3531	35	31	5
117011 NEW	ALR4238	42	38	5
117012 NEW	ALR5450	54	50	5



90.1513-BE

Straight connectors

made of acetal copolymer (POM)

Material	Acetal copolymer (POM)
Operating temperature with air	-20 to 70 °C
Operating temperature with water	1 to 70 °C



Straight connectors

Item no.	Type no.	For hose Ø, external (mm)	Working pressure (bar)	L1 (mm)
110278	67.004	4	0.00–16.0	32.6
110279	67.005	5	0.00–16.0	32.6
110280	67.006	6	0.00–16.0	35.0
110281	67.008	8	0.00–16.0	38.0
110282	67.010	10	0.00–10.0	41.9
110283	67.012	12	0.00–10.0	53.8
110284	67.015	15	0.00–10.0	58.0
110285	67.018	18	0.00–10.0	64.1
110286	67.022	22	0.00–10.0	70.6
110287	67.028	28	0.00–10.0	90.8



67.006

Y-connectors

made of acetal copolymer (POM)

Material	Acetal copolymer (POM)
Operating temperature with air	-20 to 70 °C
Operating temperature with water	1 to 70 °C

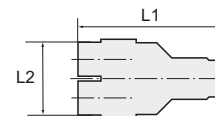

Y-connectors

Item no.	Type no.	For hose Ø, external (mm)	Working pressure (bar)	L1 (mm)	L2 (mm)
136488	89.004	4	0.00–16.0	37.0	28.5
136489	89.006	6	0.00–16.0	35.5	26.8
136490	89.008	8	0.00–16.0	50.0	41.0
136491	89.010	10	0.00–10.0	46.0	39.5
136492	89.012	12	0.00–10.0	55.5	44.2
136493	89.015	15	0.00–10.0	70.3	54.8



89.012

T-reducer connectors

made of acetal copolymer (POM)

Material	Acetal copolymer (POM)
Operating temperature with air	-20 to 70 °C
Operating temperature with water	1 to 70 °C

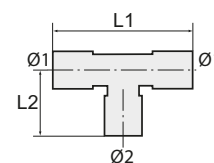

T-reducer connectors

Item no.	Type no.	For hose Ø1, external (mm)	For hose Ø2, external (mm)	Working pressure (bar)	L1 (mm)	L2 (mm)
110326	70.018-15	18	15	0.00–10.0	84.5	37.9
110327	70.022-15	22	15	0.00–10.0	90.6	41.6



70.018-15

T-connectors

made of acetal copolymer (POM)

Material	Acetal copolymer (POM)
Operating temperature with air	-20 to 70 °C
Operating temperature with water	1 to 70 °C

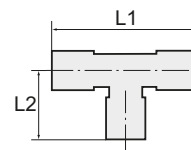

T-connectors

Item no.	Type no.	For hose Ø, external (mm)	Working pressure (bar)	L1 (mm)	L2 (mm)
110313	69.004	4	0.00–16.0	32.5	17.6
110314	69.005	5	0.00–16.0	32.5	17.6
110315	69.006	6	0.00–16.0	39.3	19.6
110316	69.008	8	0.00–16.0	42.0	21.0
110317	69.010	10	0.00–10.0	50.7	25.4
110318	69.012	12	0.00–10.0	65.0	32.5
110319	69.015	15	0.00–10.0	74.6	37.3
110320	69.018	18	0.00–10.0	88.3	44.2
110321	69.022	22	0.00–10.0	97.7	48.9
110322	69.028	28	0.00–10.0	121.4	60.7



69.006

Angle connectors

made of acetal copolymer (POM)

Material	Acetal copolymer (POM)
Operating temperature with air	-20 to 70 °C
Operating temperature with water	1 to 70 °C

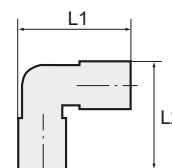

Angle connectors

Item no.	Type no.	For hose Ø, external (mm)	Working pressure (bar)	L1 (mm)	L2 (mm)
110302	68.004	4	0.00–16.0	24.1	24.1
110303	68.005	5	0.00–16.0	24.1	24.1
110304	68.006	6	0.00–16.0	27.1	27.1
110305	68.008	8	0.00–16.0	29.9	29.9
110306	68.010	10	0.00–10.0	35.3	35.3
110307	68.012	12	0.00–10.0	44.0	44.0
110308	68.015	15	0.00–10.0	50.3	50.3
110309	68.018	18	0.00–10.0	59.7	59.7
110310	68.022	22	0.00–10.0	66.6	66.6
110311	68.028	28	0.00–10.0	87.7	87.7



68.006

End pieces for pipe connection

»speedfit« series

End pieces for pipe connection, POM

Item no.	Type no.	For pipe Ø, external (mm)	Length (mm)
114062	80.012	12	20.8
114063	80.015	15	31.0
140638	80.018	18	33.3
114064	80.022	22	38.6



80.015

Straight screw-in fittings

made of acetal copolymer (POM)

Material	Acetal copolymer (POM)
Operating temperature with air	-20 to 70 °C
Operating temperature with water	1 to 70 °C

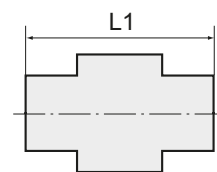

Straight screw-in fittings, external thread cylindrical with O-ring (NBR)

Item no.	Type no.	Thread	For hose Ø, external (mm)	Working pressure (bar)	L1 (mm)	SW (mm)
110259	65.018-4	G 1/8	4	0.00–16.0	22.1	14
110260	65.018-5	G 1/8	5	0.00–16.0	22.1	14
110261	65.018-6	G 1/8	6	0.00–16.0	25.3	15
110262	65.018-8	G 1/8	8	0.00–16.0	25.5	17
110263	65.014-4	G 1/4	4	0.00–16.0	24.1	17
110264	65.014-5	G 1/4	5	0.00–16.0	24.1	17
110265	65.014-6	G 1/4	6	0.00–16.0	23.8	17
110266	65.014-8	G 1/4	8	0.00–16.0	24.0	17
110267	65.014-10	G 1/4	10	0.00–10.0	31.2	20
110268	65.038-8	G 3/8	8	0.00–16.0	25.1	22
110269	65.038-10	G 3/8	10	0.00–10.0	28.2	22
110270	65.038-12	G 3/8	12	0.00–10.0	30.6	24
135950	65.038-15	G 3/8	15	0.00–10.0	42.2	22
110271	65.012-10	G 1/2	10	0.00–10.0	29.0	27
110272	65.012-12	G 1/2	12	0.00–10.0	34.0	27
110273	65.012-15	G 1/2	15	0.00–10.0	38.0	27
110274	65.012-18	G 1/2	18	0.00–10.0	54.8	-
135951	65.034-15	G 3/4	15	0.00–10.0	46.2	30
110275	65.034-22	G 3/4	22	0.00–10.0	61.2	-
135952	65.001-28	G 1	28	0.00–10.0	70.0	-



65.018-6

Safety rings

speedfit« series

Safety rings, POM

Item no.	Type no.	For pipe Ø, external (mm)	Color
135999	91.004	4	Red
136000	91.005	5	Red
136001	91.006	6	Red
136002	91.008	8	Red
136003	91.010	10	Red
114051	91.012	12	Red
114052	91.015	15	Grey
114053	91.018	18	Grey
114054	91.022	22	Grey



91.010



91.022

Protective caps

»speedfit« series

→ Protective caps to fit all POM plug-in connectors in the »speedfit« series

Color	Black		
Protective caps, POM			
Item no.	Type no.	For pipe Ø, external (mm)	Color
114055	92.012	12	Black
114056	92.015	15	Black
114057	92.018	18	Black
114058	92.022	22	Black



92.018

Loosening assists

»speedfit« series

Loosening assists, POM		
Item no.	Type no.	For pipe Ø, external (mm)
114059	93.015	15
114060	93.022	22
114061	93.028	28



93.022

Water separators

»speedfit« series

→ Prevents water from entering the stub lines.

Water separators for 22 mm pipe, POM				
Item no.	Type no.	For pipe Ø, external (mm)	L1 (mm)	L2 (mm)
114065	81.022	22	98	48

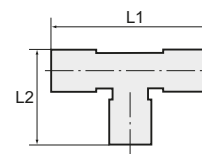

81.022

Water separators

»speedfit« series

- Prevents water from entering the stub lines, in connection with T connectors (POM).
- This insert is put into the plastic pipe, which is then inserted into the T connector.
- A quarter turn of the screw cap doubly secures the holding system!

Water separators for 28 mm pipe, brass			
Item no.	Type no.	For Pipe Ø, external (mm)	Length (mm)
114066	81.028	28	24.8



81.028

Brass connectors

»speedfit« series

Wall brackets, made of brass

Item no.	Type no.	Thread	For pipe Ø, external (mm)	L1 (mm)	L2 (mm)
114067	82.015	1/2 BSP	15	47	66.4
114068	82.022	3/4 BSP	22	52	79.0

Screw-in connectors, made of brass

Item no.	Type no.	Thread	For pipe Ø, external (mm)	Length (mm)
114073	84.012-15	1/2 BSPT	15	38.0
114074	84.034-22	3/4 BSPT	22	52.0
114075	84.100-28	1 BSPT	28	68.1

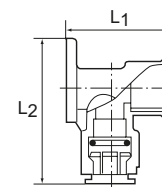

82.015



84.100-28

NEW Brass connectors

»sharkbite« series

Material	Brass
Max. operating pressure	20 bar
Operating temperature	-20 to 65 °C

Screw-on connectors, made of brass

Item no.	Type no.	Thread	For pipe Ø, external (mm)	Length (mm)
117015	AVMNG12	G 1/2	15	40
117017	AVMNG34	G 3/4	22	47
117014	AVMNG114	G 1 1/4	35	70
117013	AVMNG112	G 1 1/2	42	77
117016	AVMNG2	G 2	54	83



AVMNG34

Screw-in connector,s made of brass

Item no.	Type no.	Thread	For pipe Ø, external (mm)	Length (mm)
117029	ESVMNG12	BSPT 1/2	15	43
117031	ESVMNG34	BSPT 3/4	22	47
117028	ESVMNG1	BSPT 1	28	55
117027	ESVMNG114	BSPT 1 1/4	35	76
117026	ESVMNG112	BSPT 1 1/2	42	77
117030	ESVMNG2	BSPT 2	54	82



ESVMNG12

Straight connectors, made of brass

Item no.	Type no.	For pipe Ø, external (mm)	Length (mm)
117039	GVMN15	15	51
117040	GVMN22	22	61
117041	GVMN28	28	65
117042	GVMN35	35	99
117043	GVMN42	42	109
117044	GVMN54	54	114



GVMN15



GVMN42

Reducing connectors, made of brass

Item no.	Type no.	For pipe Ø, external (mm)	For pipe Ø1, external (mm)	Length (mm)
117051	RDVMN2215	15	22	57
117052	RDVMN2822	22	28	66
117053	RDVMN3528	28	35	94
117055	RDVMN4235	35	42	105
117056	RDVMN5442	42	54	112



RDVMN3528

NEW Brass connectors

»sharkbite« series

Repair / sliding connectors, made of brass

Item no.	Type no.	For pipe Ø, external (mm)	Length (mm)
117057	RPSVMN15	15	85
117058	RPSVMN22	22	102
117059	RPSVMN28	28	115
117060	RPSVMN35	35	163
117061	RPSVMN42	42	181
117062	RPSVMN54	54	191



RPSVMN22

T-reducing connectors, made of brass

Item no.	Type no.	For pipe Ø, external (mm)	For pipe Ø1, external (mm)
117070	TRVMN2215	22	15
117071	TRVMN2815	28	15
117072	TRVMN2822	28	22
117073	TRVMN3522	35	22
117074	TRVMN3528	35	28
117075	TRVMN4222	42	22
117076	TRVMN4228	42	28
117077	TRVMN4235	42	35
117078	TRVMN5428	54	28
117079	TRVMN5435	54	35
117080	TRVMN5442	54	42



TRVMN2815

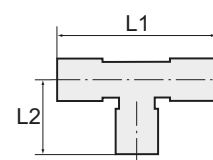

T-connectors, made of brass

Item no.	Type no.	For pipe Ø, external (mm)	L1 (mm)	L2 (mm)
117081	TVMN15	15	68	34
117082	TVMN22	22	86	43
117083	TVMN28	28	94	47
117084	TVMN35	35	139	66
117085	TVMN42	42	153	77
117087	TVMN54	54	174	85



TVMN22

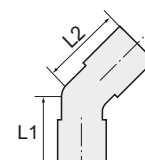

Angle connectors 45°, made of brass

Item no.	Type no.	For pipe Ø, external (mm)	L1 (mm)	L2 (mm)
117090	WVMN4515	15	28	28
117091	WVMN4522	22	43	43
117092	WVMN4528	28	40	40
117093	WVMN4535	35	61	61
117094	WVMN4542	42	67	67
117096	WVMN4554	54	72	72



WVMN4515

Angle connectors 90°, made of brass

Item no.	Type no.	For pipe Ø, external (mm)	L1 (mm)	L2 (mm)
117097	WVMN9015	15	34	34
117098	WVMN9022	22	43	43
117099	WVMN9028	28	46	46
117100	WVMN9035	35	69	69
117108	WVMN9042	42	77	77
117113	WVMN9054	54	85	85

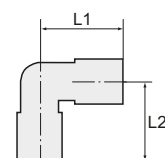

NEW Ball valves

»sharkbite« series

Material	Brass
Max. operating pressure	20 bar
Operating temperature	-20 to 65 °C

Ball valves

Item no.	Type no.	For pipe Ø, external (mm)	L (mm)	B (mm)
117045	KGHMN15	15	79	46
117046	KGHMN22	22	98	51
117047	KGHMN28	28	114	57
117048	KGHMN35	35	150	78
117049	KGHMN42	42	169	86
117050	KGHMN54	54	184	95

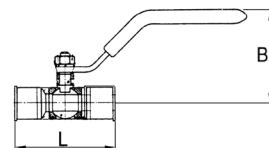

KGHMN15

NEW End caps

»sharkbite« series

Material	Brass
Max. operating pressure	20 bar
Operating temperature	-20 to 65 °C

End caps

Item no.	Type no.	For pipe Ø, external (mm)	Length (mm)
117033	EKMN15	15	26
117034	EKMN22	22	31
117035	EKMN28	28	33
117036	EKMN35	35	56
117037	EKMN42	42	62
117038	EKMN54	54	66



EKMN42

NEW Wall brackets

»sharkbite« series

Material	Brass
Max. operating pressure	20 bar
Operating temperature	-20 to 65 °C

Wall brackets

Item no.	Type no.	Thread	For pipe Ø, external (mm)	L1 (mm)	L2 (mm)
117088	WWMN15	G 1/2	15	35	45
117089	WWMN22	G 3/4	22	42	57

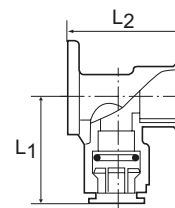

WWMN15

NEW Disassembly clips

»sharkbite« series

Disassembly clips		
Item no.	Type no.	For pipe Ø, external (mm)
117018	DMC15	15
117019	DMC22	22
117020	DMC28	28



DMC15

NEW Disassembly aids

»sharkbite« series

Disassembly aids		
Item no.	Type no.	For pipe Ø, external (mm)
117021	DMH35	35
117024	DMH42	42
117025	DMH54	54



DMH35

NEW Deburring tools

»sharkbite« series

Material	Brass	
Deburring tools		
Item no.	Type no.	For pipe Ø, external (mm)
117008	EGW3554	35–54



EGW3554

Pipe clamps

»speedfit« series

➔ For wall-mounting rigid PA or aluminum pipes.

Pipe clamps, polypropylene			
Item no.	Type no.	For pipe Ø, external (mm)	Color
114029	88.012	12	White
114030	88.015	15	White
114031	88.018	18	White
114032	88.022	22	White
114033	88.028	28	White



88.015

Pipe clamps, colored

»speedfit« and »sharkbite« series

→ For wall-mounting rigid PA or aluminum pipes.

Pipe clamps, colored, polypropylene

Item no.	Type no.	For pipe Ø, external (mm)	Color
114035	88.015-S	15	Black
114036	88.018-S	18	Black
114037	88.022-S	22	Black
114038	88.028-S	28	Black
117067 NEW	RHKL3538	35–40	Black
117068 NEW	RHKL4044	40–44	Black
117069 NEW	RHKL4854	48–54	Black
114039	88.015-B	15	Blue
114040	88.018-B	18	Blue
114041	88.022-B	22	Blue
114042	88.028-B	28	Blue
114043	88.015-R	15	Red
114044	88.018-R	18	Red
114045	88.022-R	22	Red
114046	88.028-R	28	Red
114047	88.015-W	15	White
114048	88.018-W	18	White
114049	88.022-W	22	White
114050	88.028-W	28	White



88.015-R



RHKL4854



88.015-B



88.015-W

Air distributor sockers

»speedfit« series

→ With 5 x G 1/2 female thread for screwing in adaptors and 4 self-sealing plastic screws for the threaded openings, plus G 1/2 for rapid coupling.

Air distributor sockers, plastic

Item no.	Type no.	Color
114026	86.012	Black



86.012

Air distributor sockers

»speedfit« and »sharkbite« series

→ With 2 plugs.

Air distributor sockers, aluminum

Item no.	Type no.	Input	Output
114027	87.012	G 1/2	3 x G 1/2
114028	87.034	G 3/4	3 x G 1/2



87.012

Brass connectors

»speedfit« and »sharkbite« series

Screw-in sockets, made of brass

Item no.	Type no.	Thread	For pipe Ø, external (mm)	Length (mm)
114069	83.012-15	1/2 BSPT	15	60.0
114070	83.034-22	3/4 BSPT	22	68.0
114071	83.034-28	3/4 BSP	28	80.0
114072	83.100-28	1 BSP	28	74.5



83.012-15



83.034-28



85.012-15

Screw-on sockets, female thread, made of brass

Item no.	Type no.	Thread	For pipe Ø, external (mm)	Length (mm)
114076	85.012-15	1/2 BSP	15	54.0
114077	85.034-22	3/4 BSP	22	64.5

Plastic pipe cutters

»speedfit« and »sharkbite« series

Plastic pipe cutters

Item no.	Type no.	Description
114079	259.900	For pipe Ø, external 4–28 (mm)
114080	259.901	Replacement blade (1 piece)



259.900



259.901

Aluminum pipe cutters

»speedfit« and »sharkbite« series

Aluminum pipe cutters incl. deburrer

Item no.	Type no.	Description
114078	259.800	For pipe Ø, external 4–30 (mm)



259.800



Your direct line to us.
We look forward to hearing from you.

SALES

Telephone +49 7125 9497-8320
 Mail vertrieb@riegler.de
 Online shop www.riegler.shop
 Internet www.riegler.de